



ST. LOUIS OPEN
SEPTEMBER 17-19, 2021

POWERED BY:



WELCOME TO THE ST. LOUIS OPEN!

We are excited to host you and hope you enjoy competing against our courses and each other.

Special thanks to all of our sponsors and volunteers.
It is only with their support that we can host an event of this scale.
So please take a moment to thank a volunteer and support our sponsors.

We know there are a lot of opportunities for competition in the Midwest, and we appreciate you attending our event. We strive to offer a great player experience in both fun and competition. That said, we know there are always opportunities for improvement. Please feel free to share suggestions you think will improve future efforts with our team, at the conclusion of the event.

Thanks, and have a great event!
The St. Louis Disc Golf Club Board



KEY CONTACTS

TOURNAMENT DIRECTORS

RED Pool: Jeff Irwin: (314) 753-9161

WHITE Pool: Brett Elam: (618) 910-7603

BLUE Pool: Jeff Willems: (636) 445-4447

GREEN Pool: George Fiorini: (314) 828-9399

LADIES LIAISON

Hayley Day: (618) 581-9578

LOGAN UNIVERSITY SECURITY

(636) 230-1900

<p><u>CARROLLTON PARK</u> 4256 Gallatin Lane Bridgeton, MO 63044 FRIDAY, SATURDAY, SUNDAY</p>	<p><u>LOGAN UNIVERSITY</u> 1851 Schoettler Road Chesterfield, MO 63017 FRIDAY, SATURDAY, SUNDAY</p>
<p><u>JEFFERSON BARRACKS</u> North Road West St. Louis, MO 63125 FRIDAY</p>	<p><u>ENDICOTT PARK</u> 2935 Endicott Avenue St. Louis, MO 63114 FRIDAY, SATURDAY, SUNDAY</p>
<p><u>CREVE COEUR-LAKESIDE</u> 17325 Marine Avenue St. Louis, MO 63146 SUNDAY</p>	<p><u>UNGER PARK</u> 500 Yarnell Road Fenton, MO 63026 SATURDAY</p>

POOL SCHEDULE

DIVISION	POOL	FRI	SAT	SUN
MPO	RED	Carrollton	Carrollton	Logan
FPO				
PRO MASTERS*				
MA1	WHITE	Logan	Logan	Carrollton
MA2	BLUE	Jefferson Barracks	Endicott	Creve Coeur Lakeside
MA MASTERS**				
MA3-4	GREEN	Endicott	Unger	Endicott
FA1-4				
FA MASTERS***				
ALL JR DIVS				

* PRO MASTERS: All "age-protected" PRO Divisions (MP40-MP80 & FP40-FP80) are in the **RED** pool

** MA MASTERS: All "age-protected" MA Divisions (MA40-MA80) are in the **BLUE** pool

*** FA MASTERS: All "age-protected" FA Divisions (FP40-FP80) are in the **GREEN** pool



Each of the courses used for the 2021 STLO are listed in UDisc. We recommend using the course directory function for course directions and maps.



Huge thanks to all our sponsors. Events of this magnitude cannot be executed without the help of numerous volunteers and sponsors. Please thank a volunteer and support our sponsors.

EVENT SPONSORS



EVENT SCHEDULE

WEDNESDAY, SEPTEMBER 15

10:00pm - 4:00pm - Flex-Start C-Tier at Carrollton Park
4:30pm - 5:30pm - PRO CLINIC at Endicott Park

THURSDAY, SEPTEMBER 16

3:00pm - 7:00pm - Smokin' Aces Skins Match at Logan University
4:00pm - 9:00pm - Player Check-In at Schlafly Bottleworks in Maplewood
5:00pm - 9:00pm - Schlafly Happy Hour (15% Off) at Schlafly Bottleworks in Maplewood

FRIDAY, SEPTEMBER 17

7:30am - 2:30pm - White Pool (MA1) Round 1 Tee Times at Logan University
7:30am - 2:30pm - Green Pool (MA3, MA4, FAX, FA Masters, MJXX) Round 1 Tee Times at Endicott
7:30am - 2:30pm - Blue Pool (MA2, MA Masters) Round 1 at Jefferson Barracks Hist. Park
8:30am - 3:30pm - Red Pool (MPO, FPO, PRO Masters) Round 1 at Carrollton Park
6:30pm - 9:00pm - Dark Ace GLOW at Schroeder Park

SATURDAY, SEPTEMBER 18

7:30am - 2:30pm - White Pool (MA1) Round 2 Tee Times at Logan University
7:30am - 2:30pm - Green Pool (MA3, MA4, FAX, FA Masters, MJXX) Round 2 Tee Times at Unger
7:30am - 2:30pm - Blue Pool (MA2, MA Masters) Round 2 at Endicott Park
8:30am - 3:30pm - Red Pool (MPO, FPO, PRO Masters) Round 2 at Carrollton Park
5:00pm - 9:00pm - Player's Party: FlyMart, Food, Drinks, Music, etc. at Logan University Pavilion

SUNDAY, SEPTEMBER 19, 2021

7:30am - 2:30pm - White Pool (MA1) Round 3 Tee Times at Carrollton Park
7:30am - 2:30pm - Blue Pool (MA2, MA Masters) Round 3 Tee Times at Creve Coeur-Lakeside
7:30am - 2:30pm - Green Pool (MA3, MA4, FAX, FA Masters, MJXX) Round 3 Tee Times at Endicott
8:30am - 3:30pm - Red Pool (MPO, FPO, PRO Masters) Round 3 Tee Times at Logan University
4:30pm - 6:30pm - ESTIMATED TIME - Awards Ceremony @ Logan University Pavilion



FLEX-START C-TIER
PRO CLINIC



SMOKIN' ACES SKINS
PLAYER CHECKIN
SCHLAFLY HAPPY HOUR



DARK ACE GLOW



PLAYER'S PARTY

ADDITIONAL ACTIVITIES



FLEX-START C-TIER

Carrollton Park 10:00 - 4:00

4256 Gallatin Ln. Bridgeton, MO 63044

PRO CLINIC

Endicott Park 4:30 - 5:30

2950 Endicott Avenue St. Louis, MO 63114



SMOKIN' ACES SKINS

Logan University 3:00 - 7:00

1851 Schoettler Road Chesterfield, MO 63017

PLAYER CHECKIN

Schlafly Bottleworks 4:00 - 9:00

7260 Southwest Ave. Maplewood, MO 63143

SCHLAFLY HAPPY HOUR

Schlafly Bottleworks 5:00 - 9:00 (15% off)

7260 Southwest Ave. Maplewood, MO 63143



DARK ACE GLOW

Schroeder Park 6:30 - 9:00

359 Old Meramec Station Rd. Manchester, MO 63021



PLAYERS PARTY

Logan University 5:00 - 9:00

1851 Schoettler Road Chesterfield, MO 63017

CARROLLTON PARK

4256 Gallatin Lane Bridgeton, MO 63044

COURSE NOTE: Carrollton Park has multiple baskets on SIX holes.

BLUE TOP BASKETS are in play on Holes 1, 5, 7, 9, 11, & 13.

On or over any road at Carrollton Park is OB

HOLE	PAR	DISTANCE	HOLE INFORMATION
1-D	4	738'	BLUE BASKET Road (left) and Fence (right) are OB
2-C	4	600'	Road (right) is OB
3-C	3	444'	Road (right) is OB
4-C	3	315'	Road (right/long) is OB
5-D	5	800'	BLUE BASKET Road (right/long) is OB
6-C	3	400'	Road (right/long) is OB - OB tee shot, proceed to DZ w/ 1-stroke penalty
7-D	4	535'	BLUE BASKET Road (right/long/left) is OB
8-C	4	535'	Road (left) and Fence (right) are OB
9-D	4	630'	BLUE BASKET Road (right) is OB
10-C	3	365'	Road (right/long) is OB
11-C	4	715'	BLUE BASKET Road (left) and Fence (right) are OB
12-A	3	230'	Road (left), Fence (right), & Parking Lot (long) are OB
13-D	5	800'	BLUE BASKET Fence (right) and Road (left/long) are OB
14-B	3	410'	Road (right/long) are OB
15-B	3	355'	Road (left) is OB
16-C	4	550'	Mando (Right) Stay left - DZ if missed w/ 1-stroke penalty. Road (left/long/right) are OB
17-C	3	295'	Road (left/long) are OB
18-D	4	480'	Road (right) is OB

PAR 66

Special Thanks to

Course Captain: Ethan Livaudais

Mike Pinson, Bridgeton Resident, Brendan Kane, & Craig Dew, at City of Bridgeton



LOGAN UNIVERSITY

1851 Schoettler Road Chesterfield, MO 63017

On or over any road at Logan University is OB. Do NOT park on the grass!

HOLE	PAR	DISTANCE	HOLE INFORMATION
1-B	4	500'	OG13, Road, Pond (straight), & Fence are OB
2-B	3	405'	OG14, Fence, Creek (straight), & Lake (left) are OB
3-B	3	300'	OG15, Lake (left) is OB
4-A	3	302'	OG16, Lake is OB - DZ if you do not clear water
5-B	3	291'	OG17, In <u>or</u> over creek (left) is OB
6-D	4	855'	OG18, Road is OB, In <u>or</u> over creek (left) is OB
7-B	3	269'	OG2, Road is OB
8-C	4	438'	OG3, Lake (right/ long) is OB
9-C	4	445'	OG4, Road (left) is OB
10-D	4	501'	OG5, Both Lakes & Road (long) are OB
11-A	4	505'	OG6, Lake, Creek, Road, & Rocks are OB - Proceed to DZ if you do not clear water on drive
12-C	4	573'	OG7, Road & Creek (right, straight) are OB
13-B	4	475'	OG8, The Creek (right, straight) & Road (left, Straight) are OB
14-A	3	274'	OG9, Lake is OB
15-C	3	315'	OG1
16-C	3	450'	OG10, Lake (left) & Road (right) are OB
17-C	3	325'	OG11, Gravel parking lot (right) is OB
18-C	4	639'	OG12, Mando (left) - Stay right. Re-tee if missed w/ 1-stroke penalty. Fence (left) and Parking lot (long/right) are OB

PAR 63

Special Thanks to

Course Captain: Jeff Irwin

Robert Powell MS, ATC & Blake Randell at Logan University



LOGAN UNIVERSITY

DO NOT PARK ON THE GRASS ANYWHERE AT ANYTIME
NO SWIMMING, DIVING, OR RAKING LAKES FOR DISCS

KEY INFORMATION

We are playing OG Hole 13 as Tournament Hole 1.

When you arrive on campus for Sanctioned Play, park in PARKING LOT #3.

When you arrive on campus for the Player's Party, Saturday night, park in PARKING LOT #5,6,7 OR 8.

The Player's Party is at the Pavilion, near the athletic facilities & Dr. William M. Harris Wellness Center.

LOGAN UNIVERSITY

1851 Schoettler Road | Chesterfield, MO 63017

logan.edu | 636-227-2100 | 800-782-3344

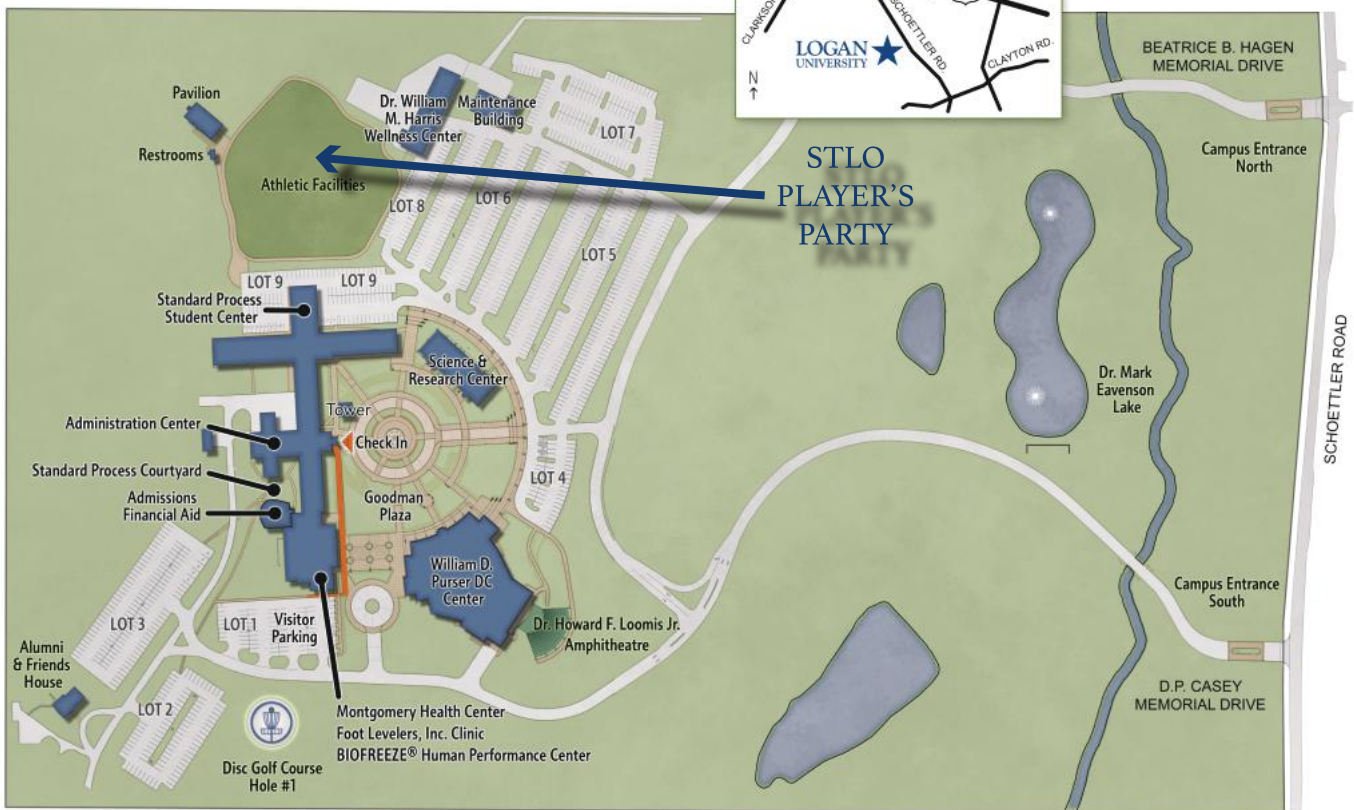

LOGAN UNIVERSITY SECURITY

(636) 230-1900

ENDICOTT PARK

2950 Endicott Avenue St. Louis, MO 63114

On or over any road at Endicott Park is OB

HOLE	PAR	DISTANCE	HOLE INFORMATION
1-B	3	297'	
2-B	4	373'	On or over walking path (long) is OB
3-C	3	291'	
4-A	3	180'	On or over road (long) is OB
5-B	3	328'	Fence (left) is OB
6-C	3	405'	Fence (left) is OB
7-B	3	346'	Fence (left) is OB
8-A	3	291'	
9-C	3	328'	Mando (right side) - stay left. DZ if missed w/ 1-stroke penalty. Concrete & Playground are OB
10-A	3	235'	
11-C	3	297'	
12-C	4	428'	
13-A	3	295'	Mando (right side) - stay left. DZ if missed w/ 1-stroke penalty
14-B	3	425'	
15-A	3	277'	
16-B	3	280'	On or over walking path (long) is OB
17-B	3	307'	
18-B	3	300'	Walking Path, Parking Lot, & Beyond are OB

PAR 56

Special Thanks to:

Course Captains: TC Brown and Khris Korzick



JEFFERSON BARRACKS PARK

North Road West St. Louis, MO 63125

On or over any road at Jefferson Barracks Park is OB

HOLE	PAR	DISTANCE	HOLE INFORMATION
1-C	3	370'	Road (right) is OB
2-B	3	354'	Road (left/long) is OB
3-B	3	340'	
4-C	3	339'	Road (right) is OB
5-D	3	450'	Road (right) is OB
6-B	3	288'	Road (left/right) is OB. Inside fence area is OB
7-D	3	350'	Road (left) is OB
8-C	4	531'	Road (left) is OB
9-B	3	330'	Road/Parking Lot (long) is OB
10-B	3	372'	
11-A	3	349'	
12-B	3	300'	Parking lot (long) is OB
13-B	3	309'	Road (long) is OB
14-B	3	258'	Road (right) is OB
15-B	3	245'	
16-A	3	253'	Parking Lot (right) is OB
17-C	4	551'	Parking Lot (right) is OB
18-C	3	355'	Mando (Left) - Stay right. DZ if missed w/ 1-stroke penalty. Parking Lot (right/long) is OB

PAR 56

Special Thanks to:

Course Captain: Aaron Walther,
The Dude, Tuesday Doubles, & Nooner Leagues



CREVE COEUR - LAKESIDE

17325 Marine Avenue St. Louis, MO 63146

On or over any road at Creve Coeur - Lakeside is OB

HOLE	PAR	DISTANCE	HOLE INFORMATION
1-B	4	540'	Mando (right) - Stay Left. Re-tee if missed Road (right/long) is OB
2-A	3	240'	
3-C	3	331'	Road (long) is OB
4-A	3	198'	Road (right/long) is OB
5-B	4	541'	Mando (left) - Re-tee if missed w/ 1-stroke penalty. Mando (Right - 200' from tee) - Stay left - DZ if missed w/ 1-stroke penalty. Road, Parking lot , & Fence are OB
6-A	3	302'	
7-C	3	381'	Fence (right) & Road (long) are OB
8-C	4	459'	Fence (right) is OB
9-B	4	511'	
10-B	3	318'	
11-A	3	306'	Fence (right) is OB
12-B	3	342'	Fence (right) is OB
13-B	4	520'	Walking Path (right) & over is OB
14-A	3	326'	Walking Path (right) & over is OB
15-A	3	342'	Road (left) is OB
16-B	4	478'	
17-A	3	232'	Walking Path (long) is OB
18-A	4	419'	Walking Path (left), Parking Lot (long) are OB

PAR 61

Special Thanks to:

Course Captains: Mike Fritz & Jim McGowan



UNGER PARK

500 Yarnell Road Fenton, MO 63026

HOLE	PAR	DISTANCE	HOLE INFORMATION
1-A	3	203'	
2-A	3	230'	
3-A	3	238'	
4-A	3	189'	
5-A	3	248'	
6-A	3	314'	Sidewalk, Pavilion & beyond are OB
7-A	4	695'	Mando (left) - stay right. DZ if missed w/ 1-stroke penalty
8-A	3	383'	Lake (left) and Road (long) are OB
9-A	4	597'	Walking Path (left) and Road (long) are OB
10-A	3	220'	Creek is OB - If OB on drive, go to DZ
11-A	3	268'	Road is OB
12-A	3	279'	
13-A	3	252'	Road is OB
14-A	3	184'	
15-A	3	186'	
16-A	3	199'	
17-A	3	209'	
18-A	3	212'	Road (right) and Parking Lot (long) are OB

PAR 56

Special Thanks to:

Course Captains: Dan Adams, Eric Clever, & Joe Jaegers



CLOSING INFORMATION

The Awards Ceremony will be hosted at the Logan University shelter (venue of the player's party) on Sunday, at approximately 4:00 pm.

All AM Divisions are paid in STLDGC Vouchers. These vouchers are good for one year (365 days) from the issue date.

Pro Divisions will be paid on MONDAY SEPTEMBER 20
Please double check your registration details and let us know prior to Monday if we should send payment to a different email.

Thanks for playing the 2021 St. Louis Open. We hope you enjoyed the event and our courses as well as good competition and camaraderie. We know there are a lot of choices for sanctioned play in the Midwest and we appreciate you visiting our area and playing our event.

Please feel free to share any improvement opportunities with our team at stldgclub@gmail.com

See you on the course,
STLDGC Board

